

**B M TECHNO MACHINES PVT LTD**

An ISO 9001, 14001 & OHSAS 18001 Company

# Automatic Storage & Retrieval Systems (AS/RS)





## Automatic Storage & Retrieval Systems (AS/RS)

It comprises of racking structure and specially designed robots which synergize to achieve accurate and high throughput.

Our ASRS is indigenously developed & manufactured by our team. It is typically used in application where high volume of inventory is moved in and out of the system. These AS/RS is computer controlled system, maintaining an accurate inventory of stored goods. It also determines and allocates storage location for the all inward goods and retrieves specified goods with high degree of accuracy on request. AS/RS is most reliable system to process complex tasks with high efficiency.



## In Feed/Out Feed Stations

BMT manufactures a compressive range of conveyor's and transfer cars. To accommodate differing throughput requirements. We have an impressive range of In feed/Out feed stations from low-cost fixed position, P&D stations through to fully automated solutions that seamlessly link receiving manufacturing, put-away, palletizing and dispatch.

## Specifications:

Maximum Load	500 Kg - 2000 Kg
Maximum Height	30 - 40 Meters
Long Travel Speed	1.0 M/Sec - 1.5 M/Sec
Long Travel Acceleration	0.25 M/Sec <sup>2</sup> - 0.4 M/Sec <sup>2</sup>
Hoisting Speed	0.5 M/Sec - 1.0 M/Sec

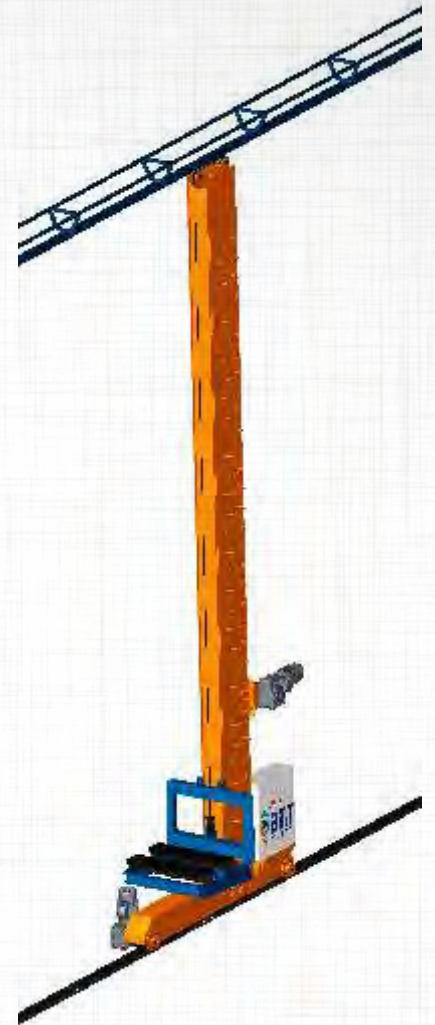

## Special Features of AS/RS

- Bar code close loop feedback system gives physical location of retrieval machines in Long Travel and Hoisting position.
- Motion of retrieval is programmed for higher speed and higher acceleration and deceleration to achieve more throughput of pallet.
- Regenerative drives are being used to convert braking energy in to electrical energy that is being feed in to line.
- WMS will help in optimum utilization of warehouse capacity, increased no. of throughput and optimum no. of retrievals.
- Optional dual wheel drive for optimal performance.

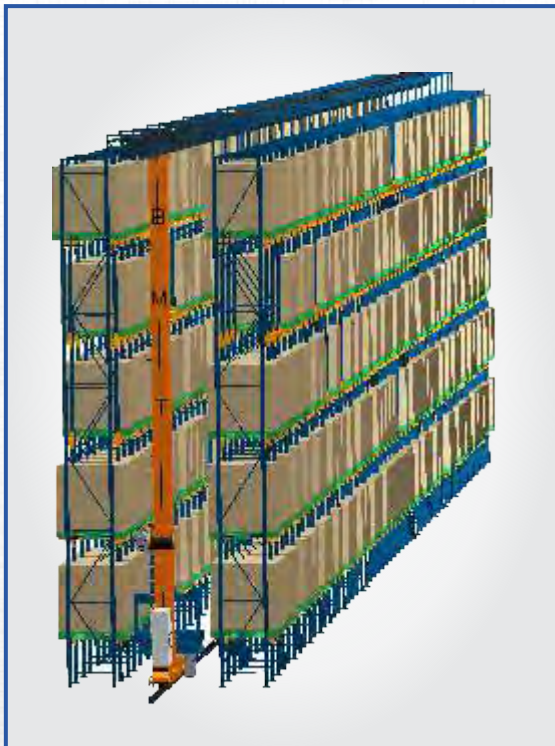

**Single Deep AS/RS**

(For high throughput)

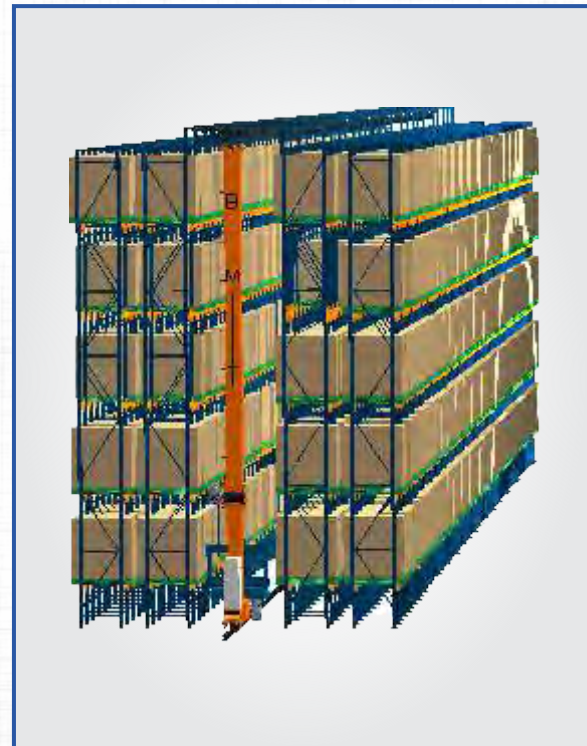

**Double Deep AS/RS**

(For high storage capacity)

# Warehouse Management System (WMS)

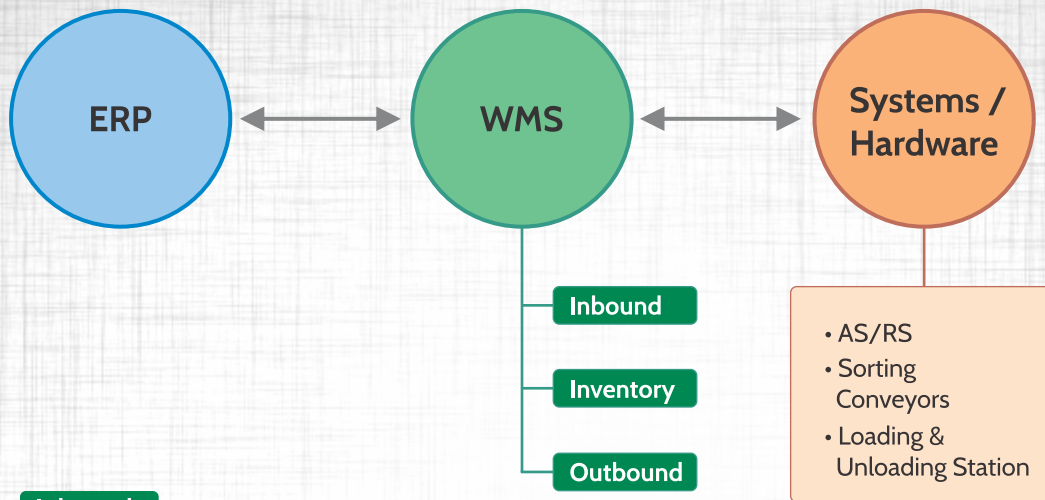

## Inbound



Material Receipt Entry



Packet Creation



Stock  
Updation  
with  
SKU details

## Inventory



### Pallet Allocation Suggestion

- Pallet allocation is the shortest path for maximum cycle count.
- Maximum utilization of pallet according to SKU details.
- Pallet allocation for optimum use of warehouse.



### Stock Transfer

- Maintain inventory as per LIFO/FIFO method, expiry of product etc.

## Outbound

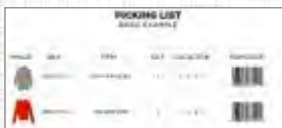

Pick List

According to dispatch for optimum use of machine.



Packing List

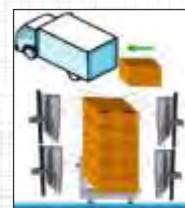

Dispatch Entry

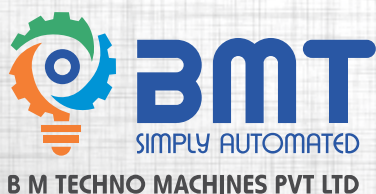

### Corp. Office:

B/502, Premium House, Nr. Gandhigram Railway Station,  
Ellis Bridge, Ahmedabad-380006. ☎ 079 4002 9602

### Works:

Unit-1: 47, Old Industrial Area, Chittorgarh, Rajasthan-312001.

Unit-2: In front of 400KV GSS, Kapasan Road Mandalda,  
Chittorgarh, Rajasthan-312001. ☎ +91 7665561815